

# Suregrip Series SR17 ERGO TIG TORCH

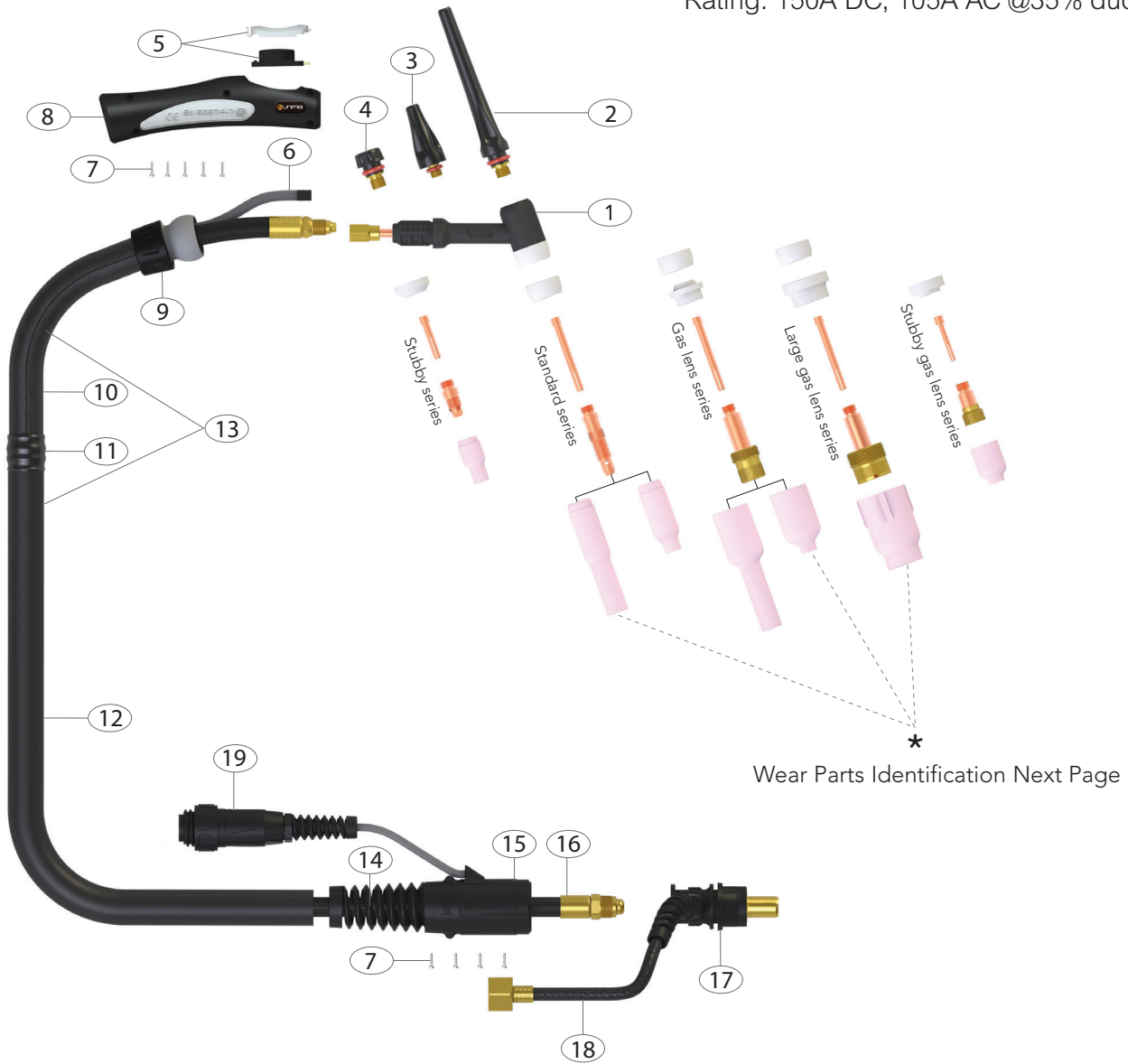

## 150A AIR COOLED TIG WELDING TORCH

Rating: 150A DC, 105A AC @35% duty cycle.



\* Wear Parts Identification Next Page

Torch Model		
Description	Part Number	
	4m	8m
SR17 Suregrip Tig Torch Package QF Gas Connect	SR-17-4MCP25	SR-17-8MCP25
	SR-17-4MCP50	SR-17-8MCP50

Spare Parts			
Part Number	Description	Part Number	Description
1	WP17 Torch head	12	UERNCL-32 Neoprene Cover X 3.2mt
	WP17F Torch head flexible		UERNCL-72 Neoprene Cover X 7.2mt
2	57Y02 Back cap long	13	UERNCL-40 Sheath X 12.5ft Inc Leather Cover
3	57Y03 Medium back cap		UERNCL-80 Sheath X 25ft Inc Leather Cover
4	57Y04 Short back cap	14	USLH917-S Cable Support Small
5	UER1MS Momentary Kit	15	USLH917-H "Surelok" Housing Small
6	UERSWL4 Trigger Lead 12.5ft	16	USL57Y01AR "Power Cable X 12.5ft "Surelok" Rubber
	UERSWL8 Trigger Lead 25ft		USL57Y03AR Power Cable X 25ft "Surelok" Rubber
7	UERSP1 Screw Pack	17	USL3550 "Surelok" Body & Support
8	UERH100 Small Ergo Tig Handle	18	USL-1-GS4 Gas Supply Hose
9	UERKJ100 Small Knuckle Joint	19	10004667 7 Pin Plug
10	UERLC200-08 Leather Cover X 0.8mt		
11	UERJK100 Jointing Repair Kit		

