

# Suregrip Series

## SB24 MIG TORCH



### 250A AIR COOLED MIG WELDING TORCH

Rating: 250A CO<sup>2</sup> 220A mixed gas EN60974-7 @ 60% duty cycle. 0.8 to 1.2mm wires

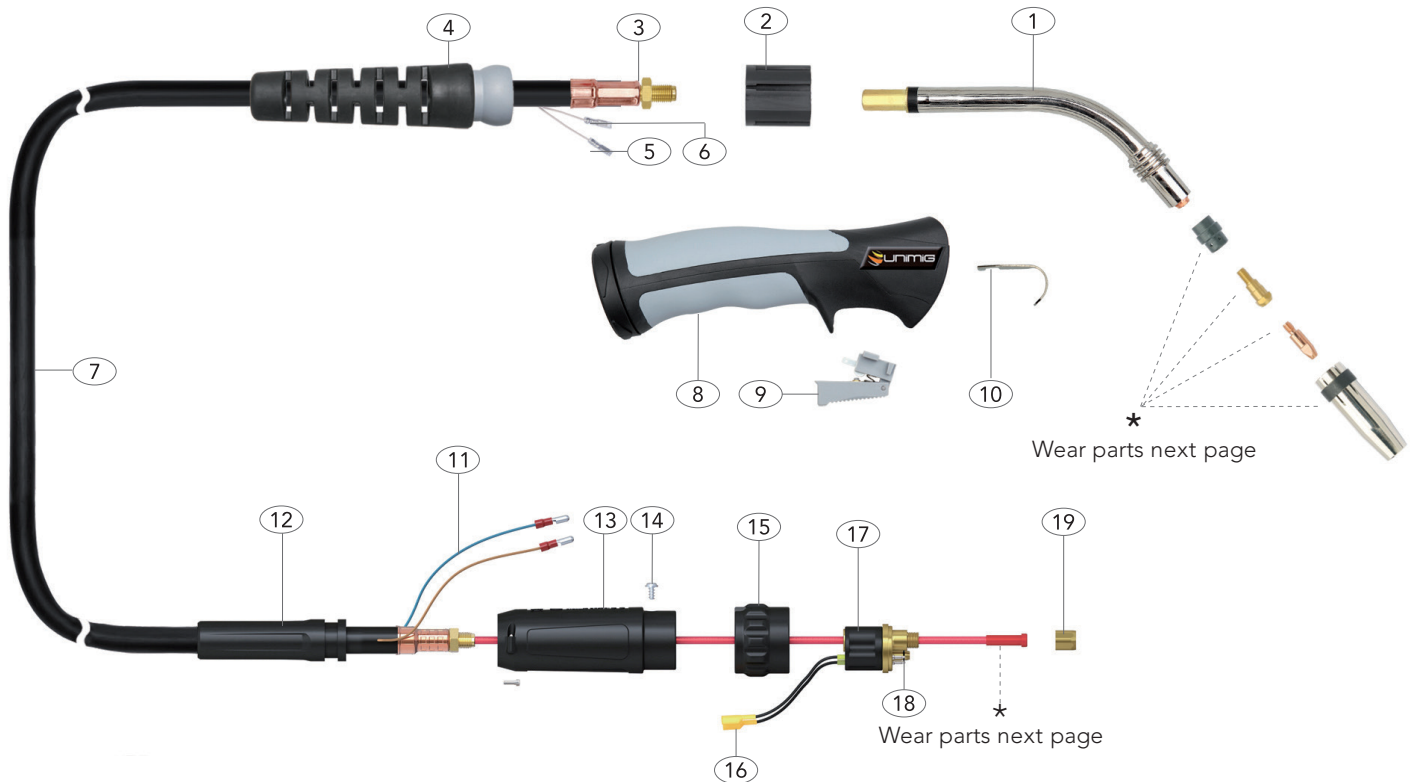

Torch Model	Description		
	Part Number	4 Mt	5 Mt
SB Suregrip Ergo Torch Package	SB24-3M	SB24-4M	SB24-5M

Spare Parts					
Part Number	Description	Part Number	Description	Part Number	Description
1	SNK24	10	UB2517	10	Hanger Hook
2	UG1515	11	UB1522	11	Cable Terminal Male
3	UB1505	12	UPA2041	12	Cable Support
4	UG8015	13	UB1518	13	Gun Plug Housing C/W Nut
5	UB1521	14	UB1541	14	Gun Plug Screw
6	UB1521-C	15	UB1519/S	15	Gun Plug Nut
7	UB2603-30	16	UB1523	16	Gun Plug Terminal Female
	UB2603-40	17	UC1528	17	Hybrid Gun Plug Body C/W Spring Pins
	UB2603-50	18	UB1524	18	Gun Plug 'O' Ring
8	UG2514	19	UB1525	19	Liner Nut
9	UG2516				

# Suregrip Series SB24 MIG TORCH



## Front end consumables

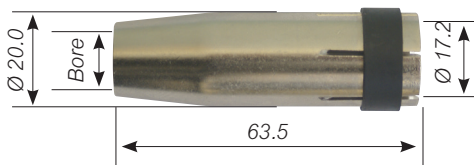
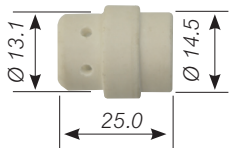
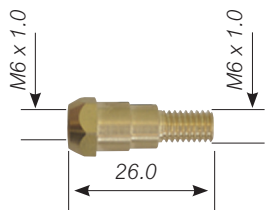
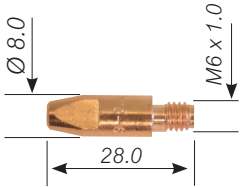

## Liners

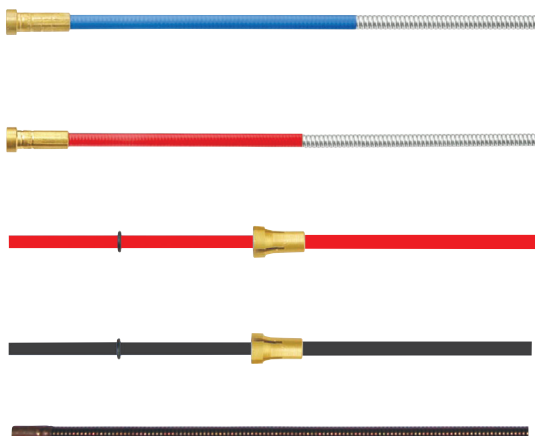

These parts are manufactured in China and are offered as replacement parts suitable for "BINZEL®" style torches.

### SB24 Contact Tips

Part Number	Description	QTY
PCT0009-06	Contact Tip Steel (0.6mm)	QTY10
PCT0009-08	Contact Tip Steel (0.8mm)	QTY10
PCT0009-09	Contact Tip Steel (0.9mm)	QTY10
PCT0009-10	Contact Tip Steel (1.0mm)	QTY10
PCT0009-12	Contact Tip Steel (1.2mm)	QTY10
PCT0009-16	Contact Tip Steel (1.6mm)	QTY10
PCTZR009-09	Contact Tip Steel Long Life (0.9mm)	QTY10
PCTZR009-12	Contact Tip Steel Long Life (1.2mm)	QTY10
PCTAL0009-09	Contact Tip Aluminium (0.9mm)	QTY10
PCTAL0009-10	Contact Tip Aluminium (1.0mm)	QTY10
PCTAL0009-12	Contact Tip Aluminium (1.2mm)	QTY10

### SB24 Tip Holder

Part Number	Description	QTY
PCTH24	Contact Tip Holder	QTY2

### SB24 Gas Diffuser

Part Number	Description	QTY
PCGD24	Gas Diffuser	QTY2

### SB24 Gas Nozzle

Part Number	Description	QTY
PGN24CYL	Cylindrical Nozzle	QTY2
PGN24CON	Conical Nozzle	QTY2
PGN24TAP	Tapered Nozzle	QTY2
PGN24SPOT	Spot Nozzle	QTY2

### SB24 Liners

Part Number	Description	QTY
SLB3M	Blue Steel Liner 3 Metre	} 0.6 - 0.8mm
SLB4M	Blue Steel Liner 4 Metre	
SLB5M	Blue Steel Liner 5 Metre	
SLR3M	Red Steel Liner 3 Metre	} 0.9 - 1.2mm
SLR4M	Red Steel Liner 4 Metre	
SLR5M	Red Steel Liner 5 Metre	
TLB3M	Blue Aluminium Liner 3 Metre	} 0.6 - 0.8mm
TLB4M	Blue Aluminium Liner 4 Metre	
TLR3M	Red Aluminium Liner 3 Metre	} 0.9 - 1.2mm
TLR4M	Red Aluminium Liner 4 Metre	
TLY3M	Yellow Aluminium Liner 3 Metre	} 1.2 - 1.6mm
TLY4M	Yellow Aluminium Liner 4 Metre	
NKSTL	Neck Spring for Aluminium	